

5. Default settings

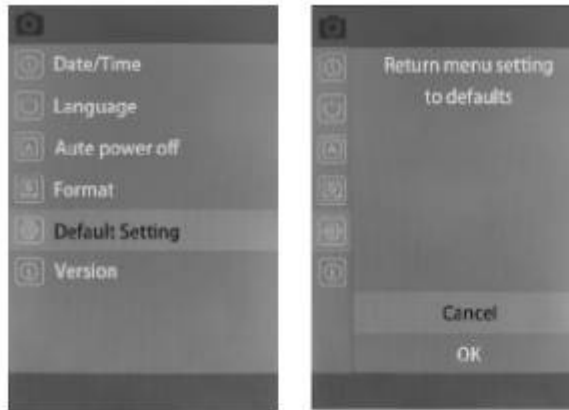

6. Version

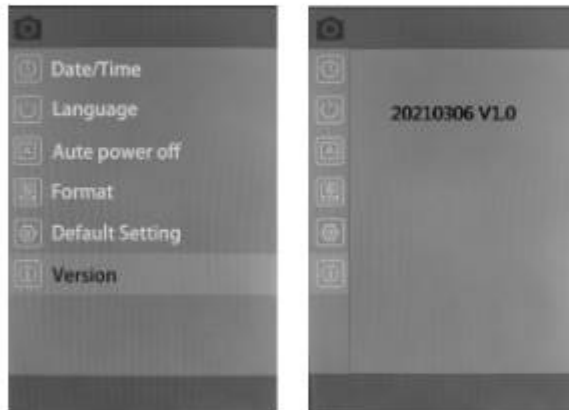

Visitor Record (View by photo)

Select PHOTO on the main interface, press OK to view

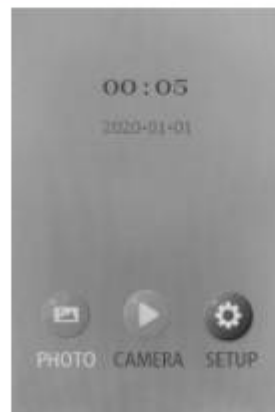

Smart lock manual



Installation instruction of anti-theft lock body

1. Accessory

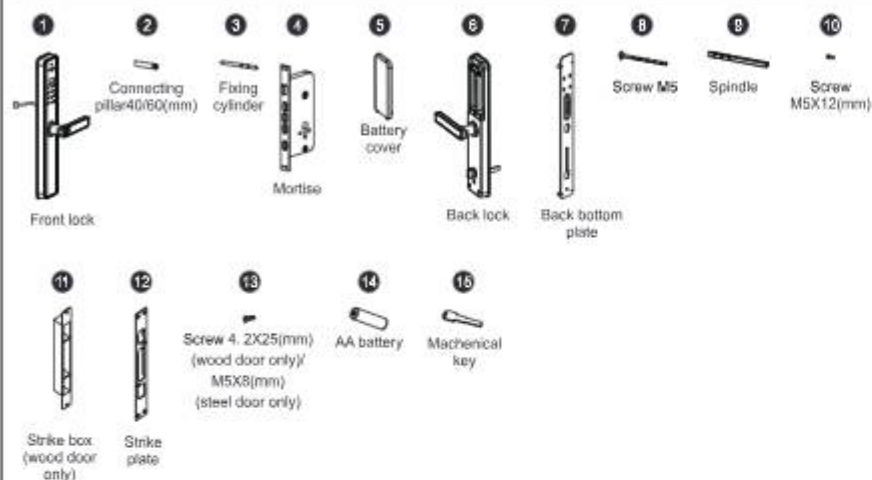

2. Door opening direction

① Right handle opening

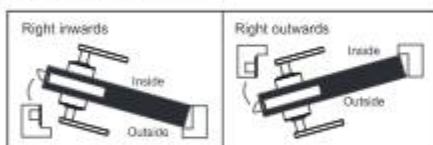

② Left handle opening

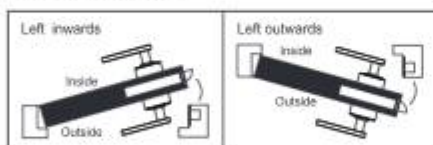

3. Adjust right handle and left handle

Release the screw with a screw driver, and turn 180 degree according to your needs to adjust the left and right, fix the screw after the handle on the correct direction.

Note: DO NOT REMOVE THE SCREW INSIDE THE HANDLE HOLD, OTHERWISE, THERE IS NO WARRANTY.

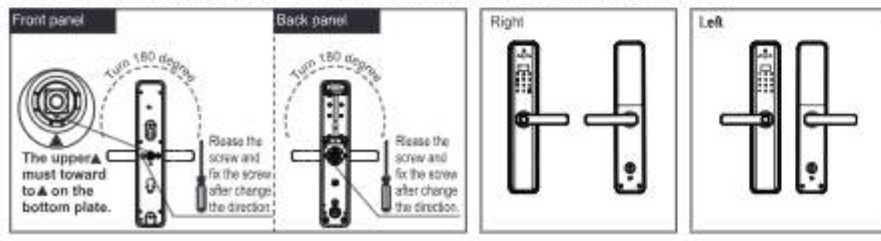

4. Adjust the mortise direction

According to the your need to adjust the mortise direction.

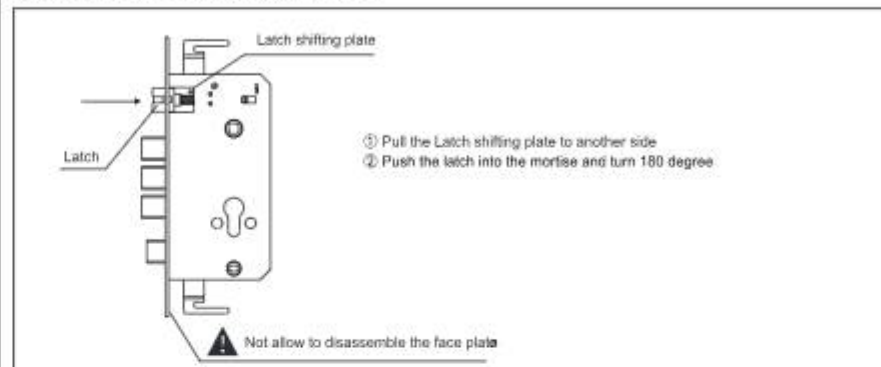

5. Accessories for sorts of door thickness

Available door thickness 40mm-120mm. If the door is over this range, please contact us for more information. Please select the correct accessories according to your door thickness.

Code and name	Specifications(mm)	door thickness ranges & QTY			
		40-60(mm)	60-80(mm)	80-100(mm)	100-120(mm)
9 Spindle (Cut the spindle according to the door thickness)		1	1	1	1
13 Screw 4.2X25(mm) (wood door only)		10	10	10	10
13 Screw M5X8(mm) (steel door only)		8	8	8	8
6 Screw M5 (Cut the screw according to the door thickness)		2 Or 2	2 Or 2	2	2
3 Fbng cylinder (Cut the fbng cylinder according to the door thickness)		2	2	2	2
2 Connecting pillar 40/60(mm)		2	2	2	2

6. Caution before installation

- ① Do not be a strong force when installation, avoid to damaging the lock.
- ② Use correct installation tools.
- ③ Wear glass to protect your eyes when drilling holes.
- ④ Drilling the door holes on both side of the door avoiding to damaging the door plate.

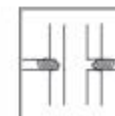
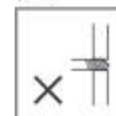
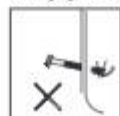

7. Installation

Installation steps:

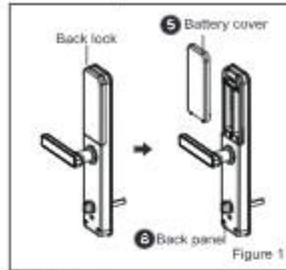

- (1) As Figure 1:
① Divide the Back Lock into Battery cover and Back panel.

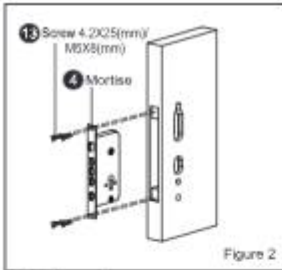

- (2) As Figure 2:
① Make the mortise cable get through the door plate, fix the mortise with 4 screws.

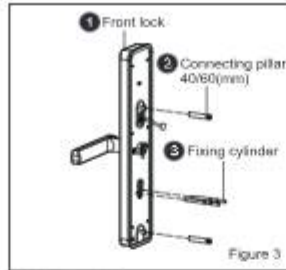

- (3) As Figure 3:
① Install the two connecting pillars with two fixing cylinders onto the front panel.

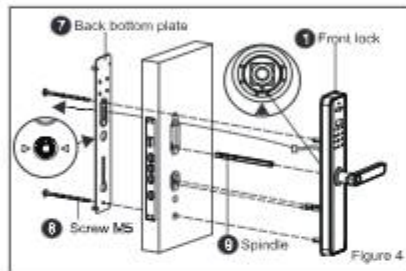

- (4) As Figure 4:
① Insert the spindle onto the mortise.
② Get the cable across the door plate and back bottom plate.
③ Fix the back bottom plate and front panel with two screws. (Note: The upper ▲ must toward to ▲ on the bottom plate), the two on the bottom plate must toward to the central of the spindle.

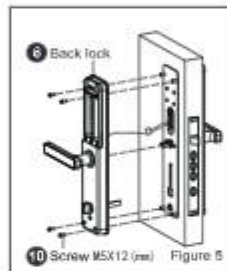

- (5) As Figure 5:
① Connect the front panel cable with the connect on the back panel.
② Fix the back panel on to the back bottom plate with 4 screws. (Note: make sure the knob is vertical).

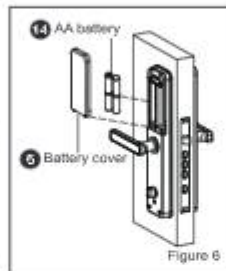

- (6) As Figure 6:
① Put the Batteries correctly and fix the Battery cover.

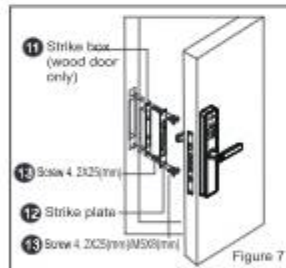

- (7) As Figure 7:
① Fix the strike box on the door frame, and then fix the strike plate with 4 screws on the door frame.

8. Check points after installation

- ① The face plate is horizontal with the door.
- ② The Latch bolt, Dead bolt and Security Bolt must works smoothly and flexibly.
- ③ The Front lock is vertical and stable.
- ④ Front handle works smoothly and flexibly, Dead bolt should be in position when you lift the handle.
- ⑤ Dead bolt should be in position when you lift the Back handle, and it should be retracted when you press the handle.
- ⑥ Knob turns smoothly and flexibly, and Security bolt reaches out or retracts should be together with the Knob's action.

Intelligent lock operation manual

1. Function and Operation

1.1 Description of terms and functional keys

1) Administrator information: refer to the Administrator's fingerprint, password or IC card.
Unlock information: refer to the input fingerprint, password, Remote control or IC card information (including Administrator and ordinary users).

2) Key^{*}: clear key/back key. Enter the password or point by clearing the previous input. Press the clear key three times in succession, empty all input.

3) Key[⊕]: confirmation key or menu function key.

2. Original state

1) The factory administrator or initial password is 123456, under the or initial state any fingerprint, IC card or password can open the lock.

2) Any fingerprint, IC card, or password which are not registered can't open the lock after inputting the administrator information.

3. Lock function management (step one)

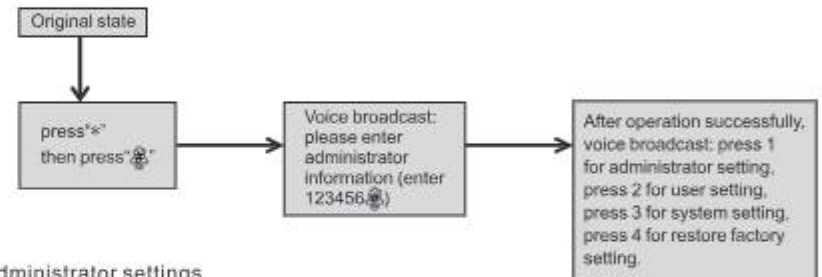

4. Administrator settings

1) Add administrator (step 2)

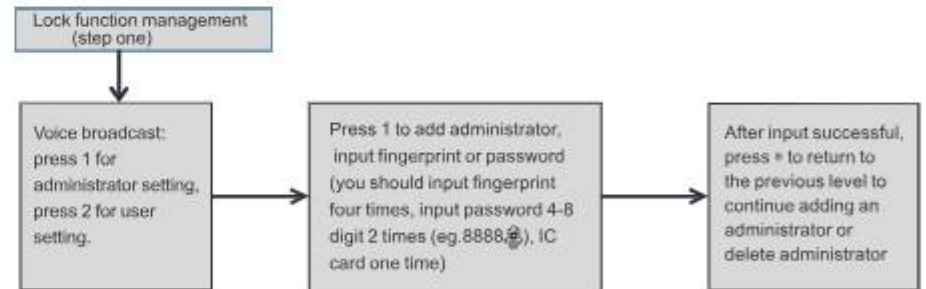

2) Delete administrator information

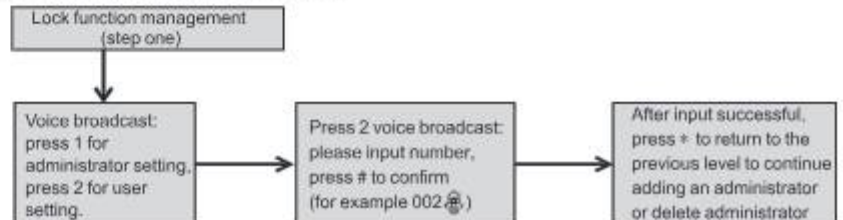

5. Common user setting

1) Add User information

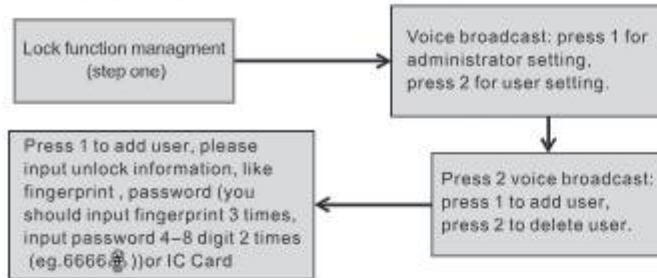

2) Delete user information

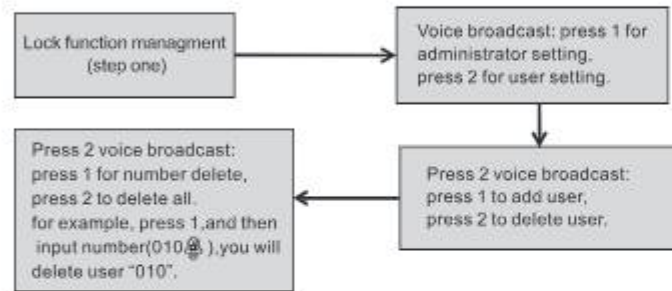

6. system setting

1) Voice setting

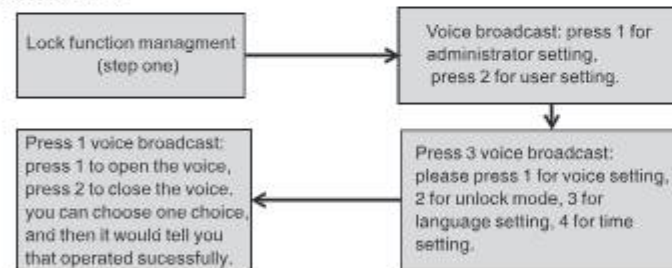

2) Unlock mode setting

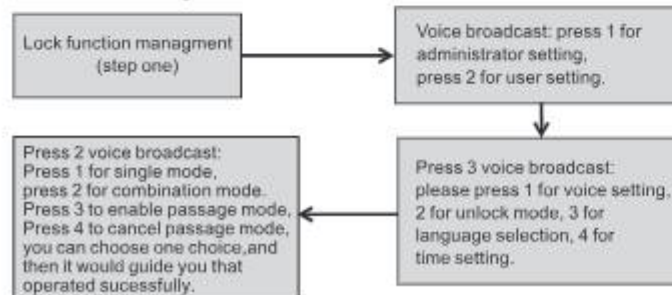

3) Language settings

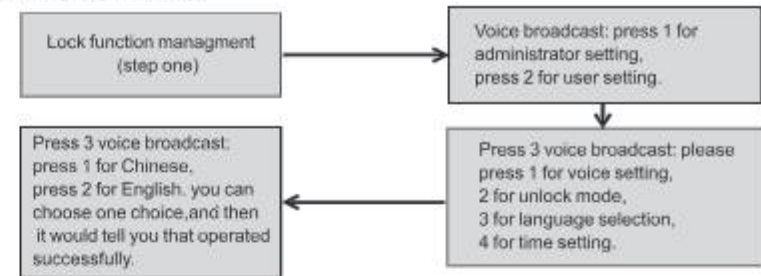

4) Time setting

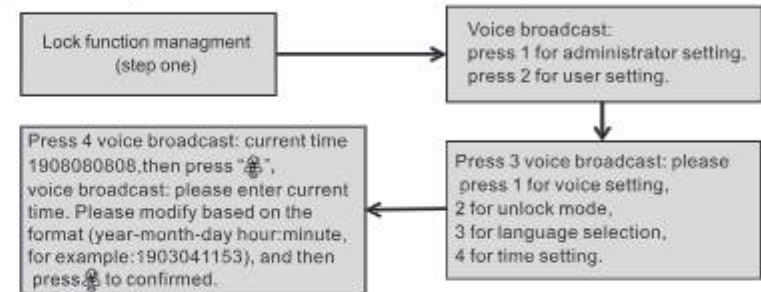

7. Restore factory settings

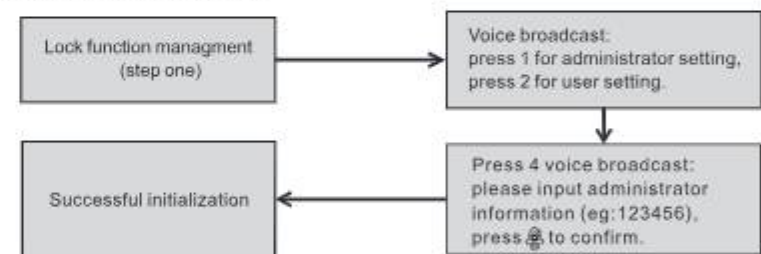

8. APP Configuration (Smart lift) - optional

- 1) Search "Smart lift" in App Store or an App market, download and install it.
- 2) Register with your cellphone number and log in.
- 3) Click "Security & Sensor", find "Lock(Wi-Fi)", click and add a device following instructions before use.
- 4) Remote unlocking: wake up the screen and press *. There will be a voice prompt: requesting remote unlocking.



9. Other notes

- 1) Input the wrong password more than 5 times in a row, the keyboard locked for 30 seconds, it does not respond to any operations in 30 seconds.
- 2) Password peeping prevention function: input password as follows when opening the door with password: XXX password XXX; you can add some extraneous codes before and after the password, and then press  to confirm. The password must be included in the input contents.
- 3) If there is no operation more than 10 seconds, system will automatically exit.
- 4) After the voltage is lower than 4.6v, the lock will automatically alarm every time when it is opened. After the alarm, the lock can be opened for about 200 times.
- 5) Remove the battery cover, press the "Set" key for 6 seconds, the lock was restored to factory mode;
- 6) In factory mode, input *333666999~~9~~* can change the language quickly;
- 7) When unlocking, input *5~~9~~* to enter passage mode (One time effective);
- 8) When unlocking, input ** to broadcast the user number;

10. Technical Parameters

Technical Parameters			
	Items	Parameters	Memo
1	Static current	$\leq 50\mu\text{A}$	
2	Dynamic current	$\leq 180\text{mA}$	
3	Administrators number	9	
4	Fingerprint number	100	
5	Fingerprint + password + card capacity	200	
6	Fingerprint Sensor	Semiconductor	
7	Fingerprint contrast time	$\leq 0.6\text{Second}$	
8	Fingerprint identification Angle	360°	
9	False Rejection Rate	$\leq 0.1\%$	
10	False Recognition Rate	$\leq 0.0001\%$	
11	Reaction time	$\leq 0.1\text{ Second}$	
12	Power type	6V	
13	Emergency power	5VDC	
14	Working temperature	$-25^\circ\text{C}\sim 60^\circ\text{C}$	
15	Working Relative Humidity	20%~90%RH	
16	Human voice	Yes	
17	Keyboard	Touch standard 12-bit keyboard (The viewer may not work properly when the power voltage is lower than 5V)	
18	Password Length	4-8 digits	
19	Phantom password	32 digits	
20	Low voltage alarm	$4.6\pm 0.2\text{V}$	
21	Unlock time	$\leq 1\text{Second}$	

Tuya APP operation instructions

Download and install

The iOS version software can be downloaded from the app store, and the Android version can be downloaded from google play.



Open Tuya Smart APP



Smart life

Operation of Tuya Smart APP

1. Register an account

Enter the Tuya Smart APP, click "Register" in the upper right corner, enter the account registration interface, support mobile phone and email account registration, choose any method.



2. Login account

Log in—enter account
—Enter the corresponding password
—login successful



3. Add device

Step 1: Press "*" + "3" to authenticate administrator identity and then press "1" to access administrator settings.

Then there will be a voice prompt of pressing "3" for network configuration.

2) Voice prompt in network configuration mode: press "1" for hotspot connection and "2" for intelligent connection.

3) When the network is successfully added, the 1st, 2nd, 3rd and 4th lights on the keyboard will be on in order with a voice prompt of "operation completed".

4) In the event of network addition failure, the 1st, 2nd, 3rd and 4th lights on the keyboard will not be on and there will be a voice prompt of "operation failed" upon timeout.

Notice:

Please add administrator before setting.

Step 2: Add Device - Security Monitoring - "Door Lock - WI-FI"



Add device



Security Monitoring



lock (WI-FI)

4. Connect to WIFI, enter the password of the connected WIFI, click Next.



5. Follow the steps, the next step.



6、 Select Wi-Fi fast connection



7、 Wait for the distribution network



8、 The distribution network is successful, enter the home door lock PRO

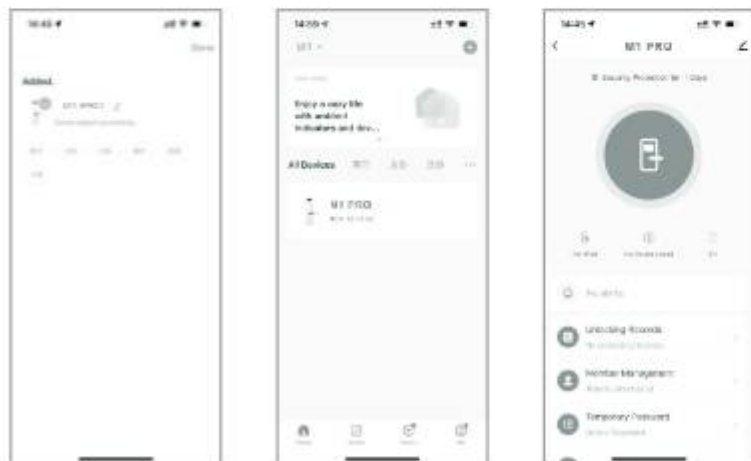

9、 Press the doorbell to unlock remotely

Remote unlocking is triggered by locking the doorbell, the guest requests, the owner unlocks, as shown below:
smart door lock—remote request—unlock

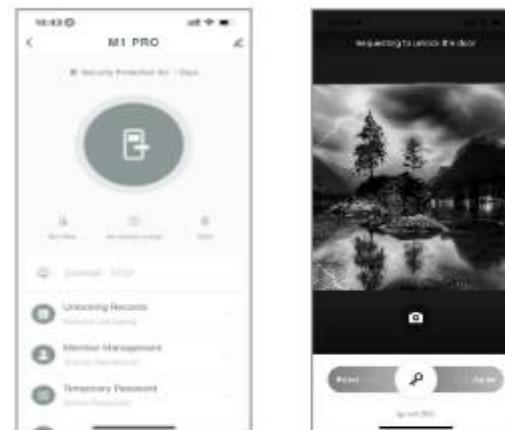

10、 user list

Click the door opening record to view the remote information, the alarm message interface displays the image of the customer who pressed the doorbell remotely, and the operation log interface displays the unlocking information, as shown below:



Rear Display Description

Button function

Three buttons: UP/key screen Power button DOWN/return key

Interface description



Video interface: Press the doorbell, or press the power button to display, you can check the recording status.

Main interface: Press the key/return key on the image interface to enter the main interface, press the up and down keys to select PHOTO, CAMERA, SETUP, and then press the power/OK key to enter the corresponding interface.

Menu function description

1. Date/Time



13

2. Language settings



3. Automatic shutdown

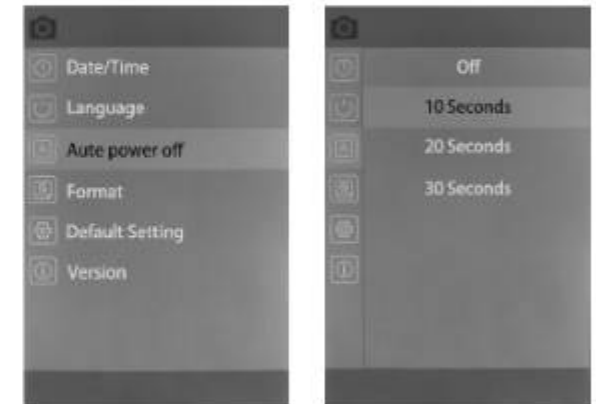

4. Formatting

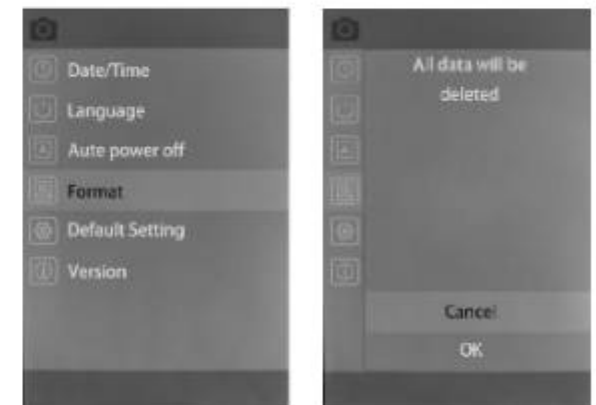

14